

T18 + I-CON X2

Bench scale T18 + I-CON X2

INTRODUCTION

Sonic Bench scale T18 adopts high anti-jamming single-chip microprocessor and high precision $\Sigma - \Delta$ A/D conversion technology, widely applied in platform scale, platform balance and other weighing applications.

FEATURES

- Built in rechargeable battery
- Strong alloy steel construction
- High Quality stainless steel plate
- High Quality Load Cell
- Accumulating function
- Built in RS-232
- Auto power saving mode & auto off function
- Selectable weighing capacity and precision
- High & Low alarm function
- Suitable for industrial environment
- Overload protection load cell
- High bright red led display
- Accurate and super stability
- Easy to calibrate
- 100% Quality guarantee load cell and indicator

SPECIFICATION

Model	Bench Scale T18	
Platter size (cm)	24x30	42x50
Mak. Capacity (kg)	3, 6, 10, 15, 30	60, 150, 200
Readability (g)	2, 5	5, 10, 20
Display	Red LED	
Rechargeable battery	6V 4Ah	
RS-232	√	
Resolution	1/30.000	



T18 + I-CON X2

Smart solution for practical work

Bluetooth Of Things

I-CON X.2

I-CON X.2 is a development of the previous version (I-CON X.1) which is a new product of innovation in data communication. By using I-CON X.2, indicators can be connected with various types of additional devices such as external displays, printers, etc without using cables. The difference between I-CON X.2 and the previous version is that there is Bluetooth support. With this technology, indicators can be integrated with smartphone, laptop, bluetooth printer, etc. I-CON X.2 is a smart and practical solution to be able to operate multiple devices in one command.



Integration for convenience

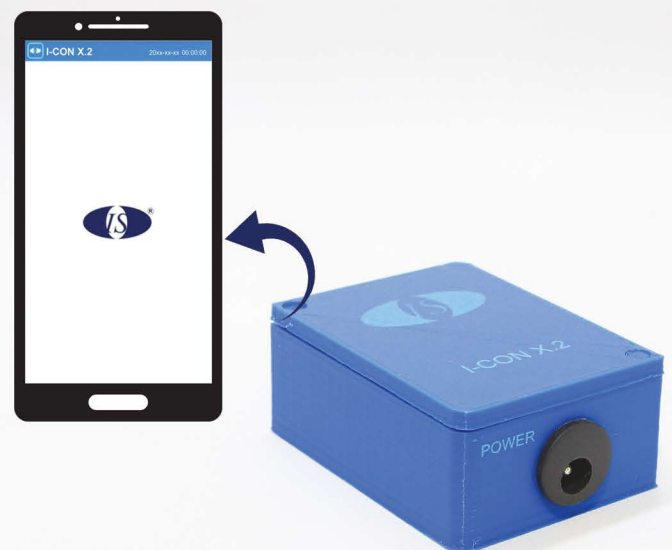

Connect with various devices
without using cable

Bluetooth support

Integrated with smartphone,
laptop, bluetooth printer, etc